

**STRAIGHT COUNTER FRONT**

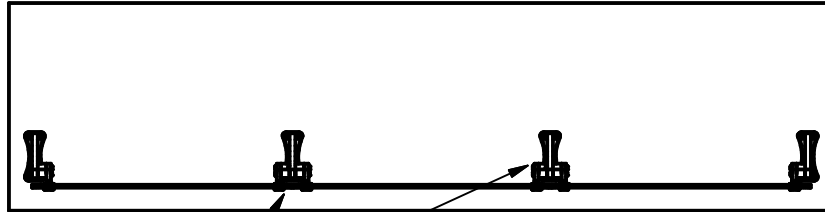

ON STRAIGHT COUNTERS UNITS MAY SHARE INTEGRAL CENTER SUPPORTS.

**FACETED OR CURVED COUNTERS**

- MINIMUM OF TWO SUPPORTS PER SEGMENT
- NO SHARED SUPPORTS AT CORNERS OR ANGLES

**FACETED COUNTER FRONT**

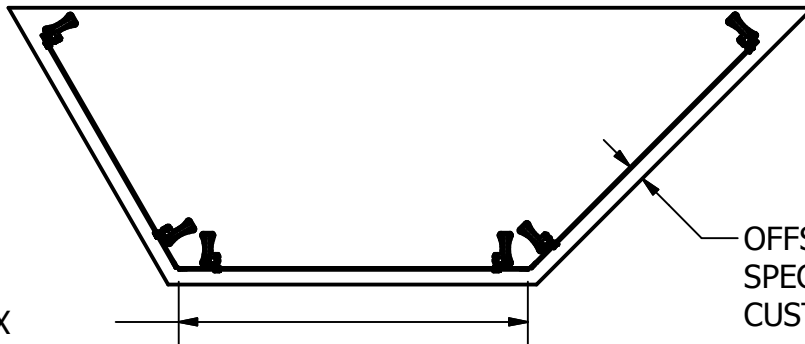

48" MAX  
GLASS SEGMENTS O.A.

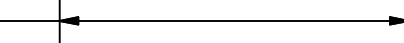

OFFSET AS  
SPECIFIED BY  
CUSTOMER

**RADIUS COUNTER FRONT**

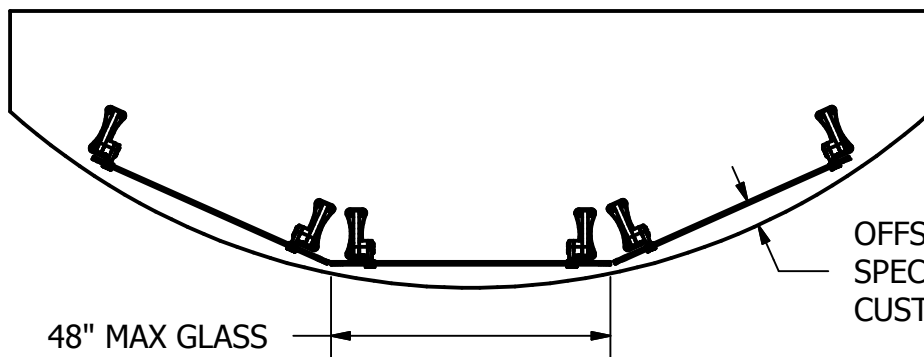

48" MAX GLASS  
SEGMENT O.A.

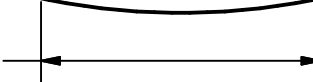

OFFSET AS  
SPECIFIED BY  
CUSTOMER

